

# FP-DX12-2X1

(400 lb. WLL)

## CLUSTER PACK PLANAR ARRAY KIT

**FASPAC™**



Clustering and flying Fulcrum DX12 series loudspeakers is easy, safe and very predictable. This planar array suspension kit joins two DX12 cabinets together to be flown as one, tight-packed for near field placement or splayed out for further distances from the audience.

Two plates come in the kit, one top and one bottom, with load rated eyebolts that provide the actual suspension. They pass through the plate and into the cabinet's threaded attach points.

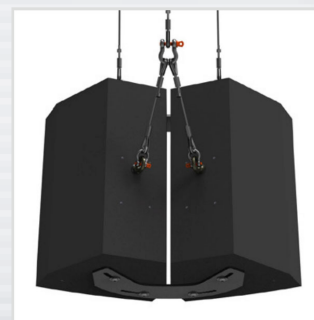

### SPECIFICATIONS:

**Materials:** Steel Alloy

**Finish:** Powder Coat

**Color:** Black

**Design Factor:** 5:1 ratio

**WLL :** 400 lb. / 182 Kg.

**Shipping Weight :** 13.4 lb. / 6.1 Kg.

### PACKAGE CONTENTS:

**2 pcs.** Joiner Plates

**2 pcs.** Eyebolt, M10X1.5-50mm

**2 pcs.** Eyebolt, M10X1.5-35mm

**1 pc** Hardware Kit



MADE IN USA



Rated for indoor use.

### DIMENSIONS:

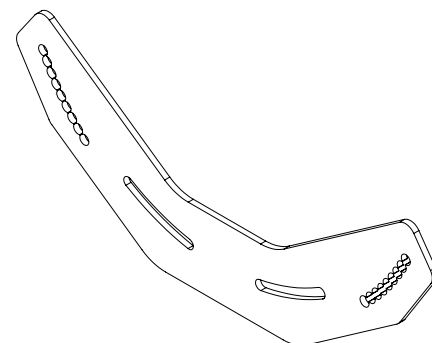
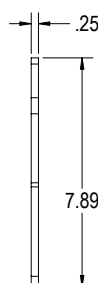
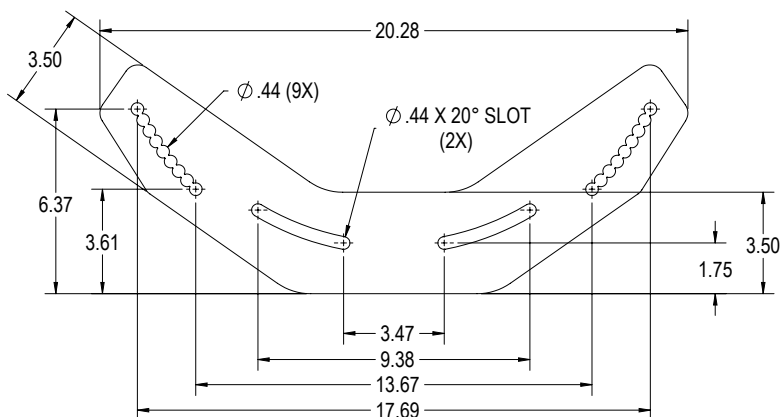

**Adaptive Technologies Group**  
1635 E. Burnett Street | Signal Hill, CA 90755 USA  
Ph: 562.424.1100 | Fax: 562.424.3520  
www.adaptivetechnologiesgroup.com



### ALWAYS INSTALL SAFETY CABLES

**WARNING:** Mounting and/or suspension of equipment requires experienced professionals. Improperly installed equipment can result in property damage, personal injury and/or liability to the installing contractor.