

# MM-3RDX-18-V2

# 70 lb WLL

## CEILING SPEAKER MOUNT WITH 3 AXES OF ADJUSTMENTS

## MULTIMOUNT®



The MM-3RDX-18-V2 is an adjustable ceiling speaker mount that provides pan, tilt & roll adjustments. It supports and aims speakers that are equipped with 4-point rectangular mounting patterns.

This extremely versatile mount aims speakers from overhead by way of a variety of pipe extensions, ceiling and strut attachments. Its dual-axle design achieves up to 360 degrees of horizontal pan angle, up to 180 degrees of tilt angle and up to 180 degrees of roll adjustment, perfect for any immersive audio application.

The MM-3RDX-18-V2's pipe coupler provides a pathway for signal wire and a safety cable to pass through the pipe extension and to the terminal block. This makes for a clean, safe and predictable method for installing and aiming ceiling speakers.



**Star Grid**  
Compatible Component

### STANDARD FEATURES:

- ▶ Angle Indicators save time aiming speakers
- ▶ Independent pan, tilt & roll adjustments
- ▶ Adapts to standard schedule-40 1/2" pipe
- ▶ Independent, no memory locking

### OPTIONAL ACCESSORIES:

- ▶ Ceiling Attachments - See Datasheets
- ▶ Pipe Extensions - See Datasheets
- ▶ Safety Cables - See Datasheets

### DIMENSIONS:

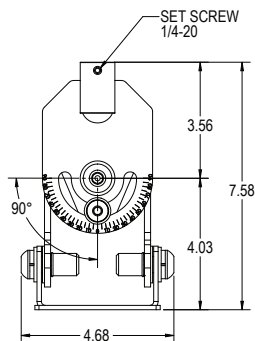

Front View

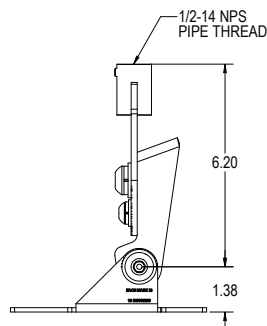

Side View

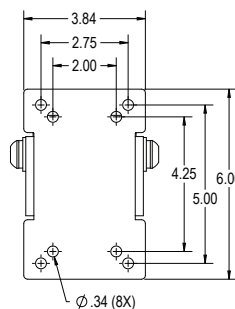

Bottom View

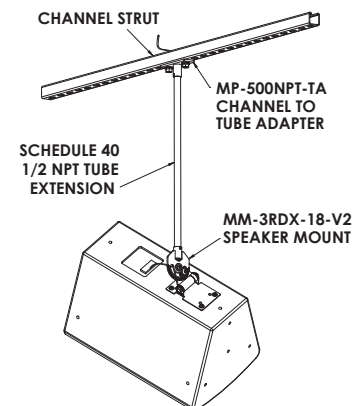

### SPECIFICATIONS:

**Material:** Structural Steel Alloy  
**Finish:** Powder Coat  
**Color:** Black  
**Tilt Rotation:** 90 degrees max  
**Pan Rotation:** 360 degrees  
**Roll Rotation:** 180 degrees  
**WLL:** 70 lb / 32 Kg max.  
**Design Factor:** 5:1 ratio  
**Net WGT:** 5 lb. (2.3 Kg.) each  
**Shipping WGT:** 6 lb. (2.7 Kg.) each  
**Pack Count:** 1 unit/carton

### PACKAGE CONTENTS:

1 pc 3-axis mount

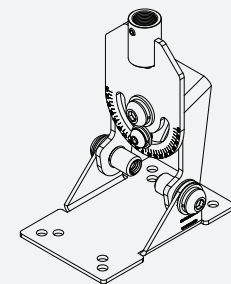

**Adaptive Technologies Group**  
1635 E. Burnett Street | Signal Hill, CA 90755 USA  
Ph: 562.424.1100 | Fax: 562.424.3520  
www.adaptivetechgroup.com



### ALWAYS INSTALL SAFETY CABLES

**WARNING:** Mounting and/or suspension of equipment requires experienced professionals. Improperly installed equipment can result in property damage, personal injury and/or liability to the installing contractor.